

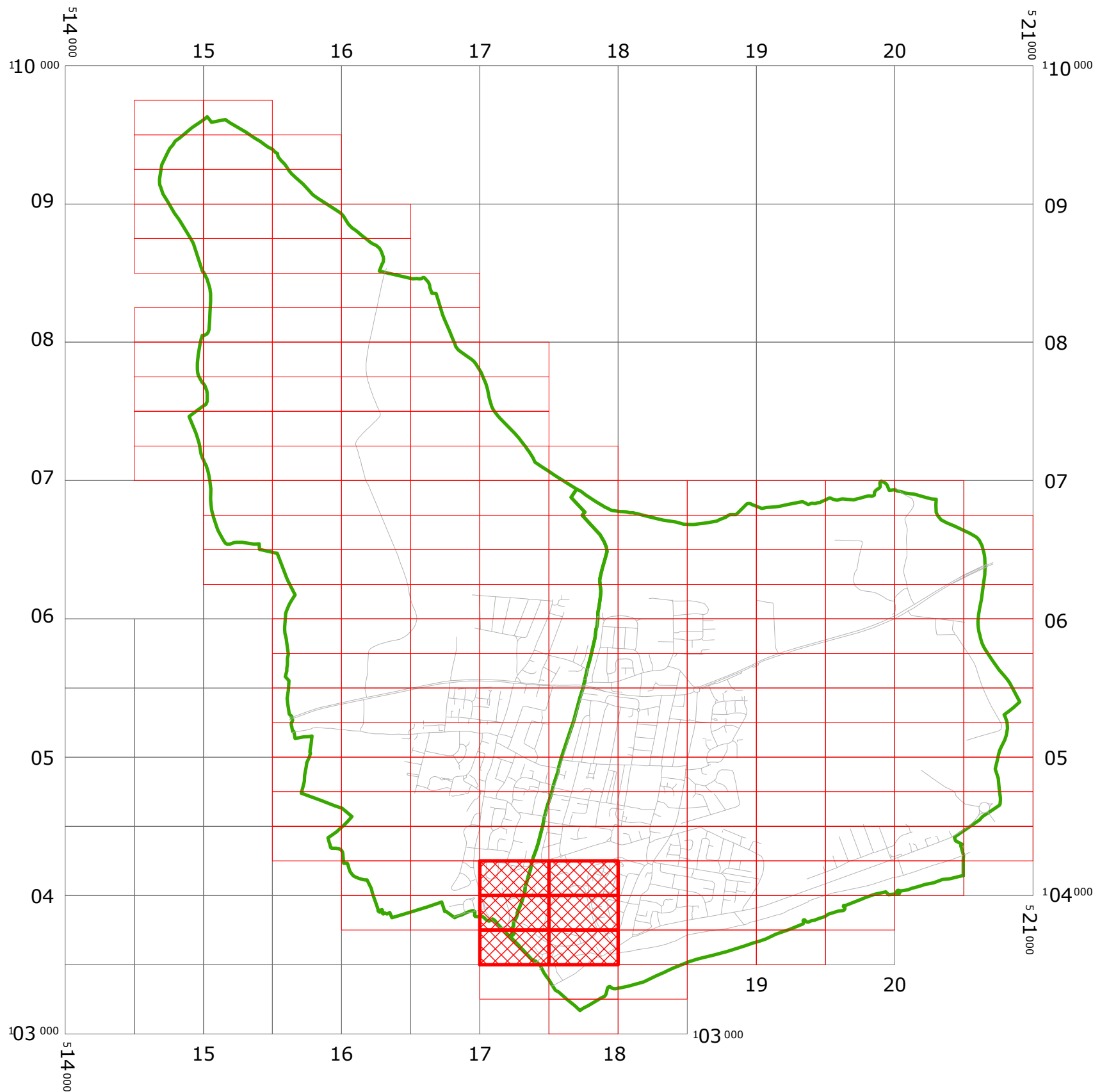



WEST SUSSEX COUNTY COUNCIL  
((ADUR DISTRICT) (PARKING PLACES AND TRAFFIC REGULATION)  
(CONSOLIDATION) ORDER 2009))  
(LANCING BUSINESS PARK AMENDMENT) ORDER 2011

# LANCING AND SOMPTING: LOCATION OF WAITING RESTRICTIONS

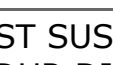

**KEY:**

-  PARISH BOUNDARY
-  OS TILE GRID
-  PARKING TILE GRID
-  LOCATION OF WAITING RESTRICTIONS
-  ROAD NETWORK



West Sussex County Council  
 Infrastructure  
 The Grange  
 Tower Street  
 Chichester  
 West Sussex  
 PO19 1RH

WEST SUSSEX COUNTY COUNCIL  
 ((ADUR DISTRICT)  
 (PARKING PLACES AND TRAFFIC REGULATION)  
 (CONSOLIDATION) ORDER 2009)  
 (LANCING BUSINESS PARK AMENDMENT) ORDER 2011

LOCATION OF WAITING RESTRICTIONS



Reproduced from or based upon 2010 Ordnance Survey mapping with permission of the Controller of HMSO (c) Crown Copyright reserved. Unauthorised reproduction infringes Crown copyright and may lead to prosecution or civil proceedings West Sussex County Council Licence No. 100023447

SCALE: 1:35,000  
 07/11/2011

**Key for Waiting Restrictions**

All areas over which the provision of the orders apply are defined by the shaded areas as shown on the following plans plus a contiguous area not indicated on the plans of verge and/or footway between the carriageway edge and the highway boundary. The plans in this schedule are based upon grid references of the Ordnance Survey National Grid defined by the OSGB 36 triangulation.

**Prohibition of waiting**

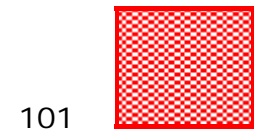

101 **check**

No waiting at any time

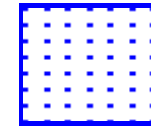

112 **dot5**

No waiting 8.00am-6.00pm Mon-Fri

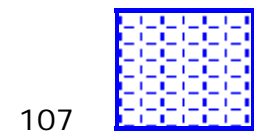

107 **pat020**

No waiting 8.00am-6.00pm Mon-Sat

**Free Limited Waiting**

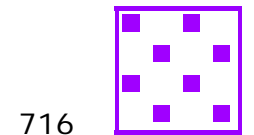

716 **shd62**

Waiting limited to 1hr No return within 1hr  
8.00am-6.00pm Mon-Sat



District Boundary

**WEST SUSSEX COUNTY COUNCIL**  
**((ADUR DISTRICT) (PARKING PLACES AND TRAFFIC REGULATION)**  
**(CONSOLIDATION) ORDER 2009)**  
**(LANCING BUSINESS PARK AMENDMENT) ORDER 2011**

West Sussex County Council in exercise of their powers under Sections 1 (1) 2 (1) and (2), 4 (2), 45, 46, 49 and 53 and Part IV of Schedule 9 of the Road Traffic Regulation Act 1984 "the Act" as amended and of all other enabling powers and after consultation with the chief officer of police in accordance with Part III of Schedule 9 to the Act hereby make the following Order:-

1. This Order shall come into operation on the 7<sup>th</sup> day of November 2011 and may be cited as "West Sussex County Council ((Adur District) (Parking Places and Traffic Regulation) (Consolidation) Order 2009) (Lancing Business Park Amendment) Order 2011."
2. The "West Sussex County Council (Adur District) (Parking Places and Traffic Regulation) (Consolidation) Order 2009" is hereby amended by the deletion from it of the plans specified in the First Schedule to this Order and the substitution of the plans attached in the Second Schedule to this Order.

**FIRST SCHEDULE**  
**Plan numbers to be revoked**

- TQ1703NEN (Issue No. 1)
- TQ1703NES (Issue No. 1)
- TQ1703NWN (Issue No. 1)
- TQ1703NWS (Issue No. 1)
- TQ1704SES (Issue No. 1)
- TQ1704SWS (Issue No. 1)

**SECOND SCHEDULE**  
**Plans to be substituted**  
**(as attached)**

- TQ1703NEN (Issue No. 2)
- TQ1703NES (Issue No. 2)
- TQ1703NWN (Issue No. 2)
- TQ1703NWS (Issue No. 2)
- TQ1704SES (Issue No. 2)
- TQ1704SWS (Issue No. 2)

The COMMON SEAL of WEST SUSSEX COUNTY COUNCIL was hereto affixed  
the FIRST day of NOVEMBER 2011  
in the presence of

  
Authorised Signatory

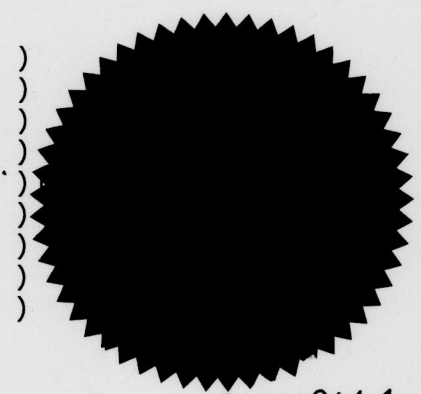

I HEREBY CERTIFY THIS TO  
BE A TRUE COPY OF THE  
ORIGINAL DOCUMENT

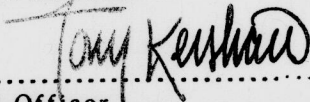
  
.....  
Authorised Officer

83012111  
C/O 8 DELEGATED AUTHORITY

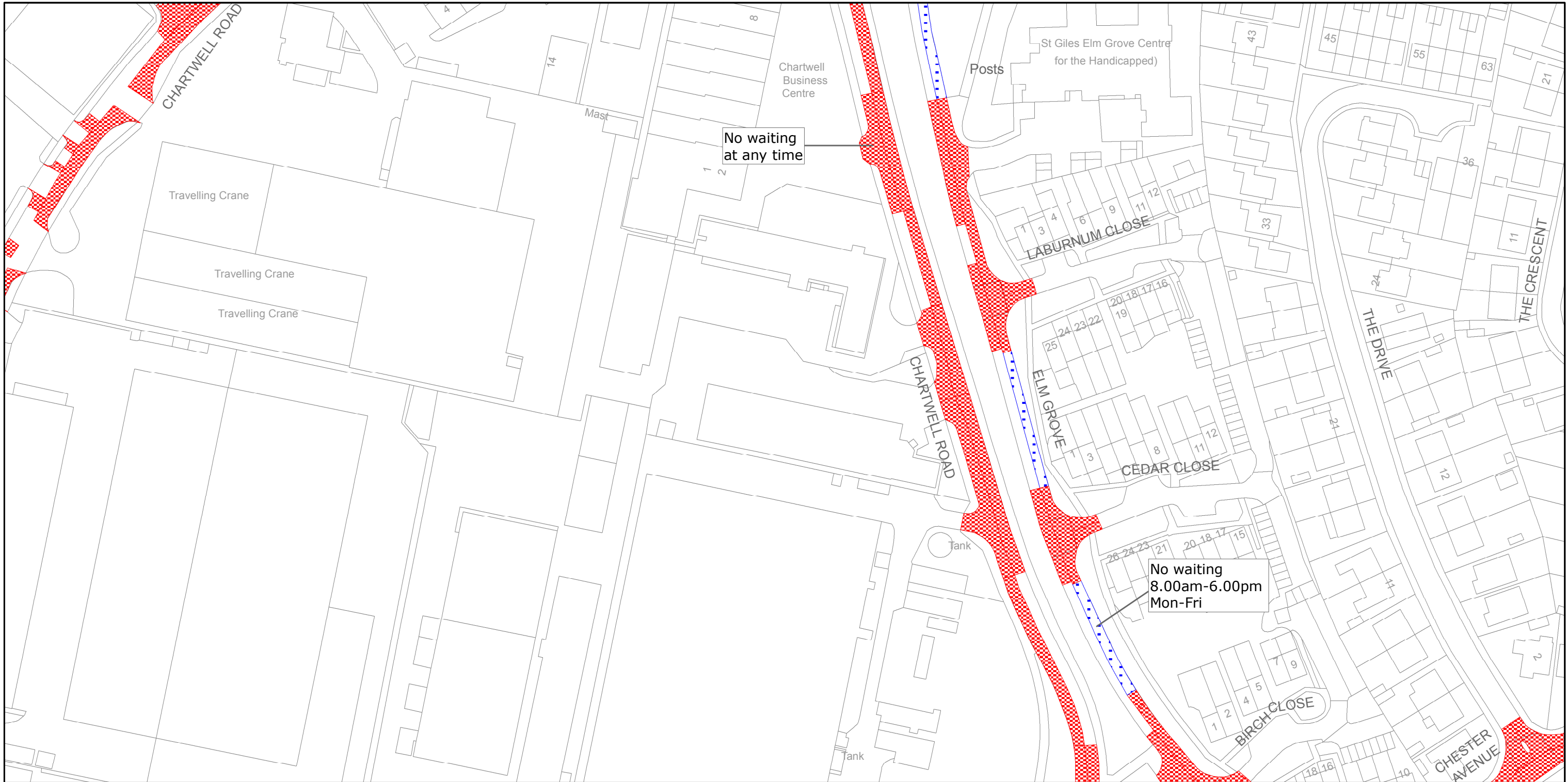

No waiting  
at any time

No waiting  
8.00am-6.00pm  
Mon-Fri



West Sussex County Council  
Highways & Transport  
The Grange  
Tower Street  
Chichester  
West Sussex  
PO19 1RH

ADUR DISTRICT: LANCING  
WAITING RESTRICTIONS

TILE REF NO:  
TQ1703NEN

SHEET ISSUE NO 2

SHEET ACTIVE FROM - 07/11/2011



SCALE:  
1:1250  
at A3 size

Reproduced from or based upon 2010 Ordnance Survey mapping with permission of the Controller of HMSO (c) Crown Copyright reserved.  
Unauthorised reproduction infringes Crown copyright and may lead to prosecution or civil proceedings West Sussex County Council Licence No. 100018485



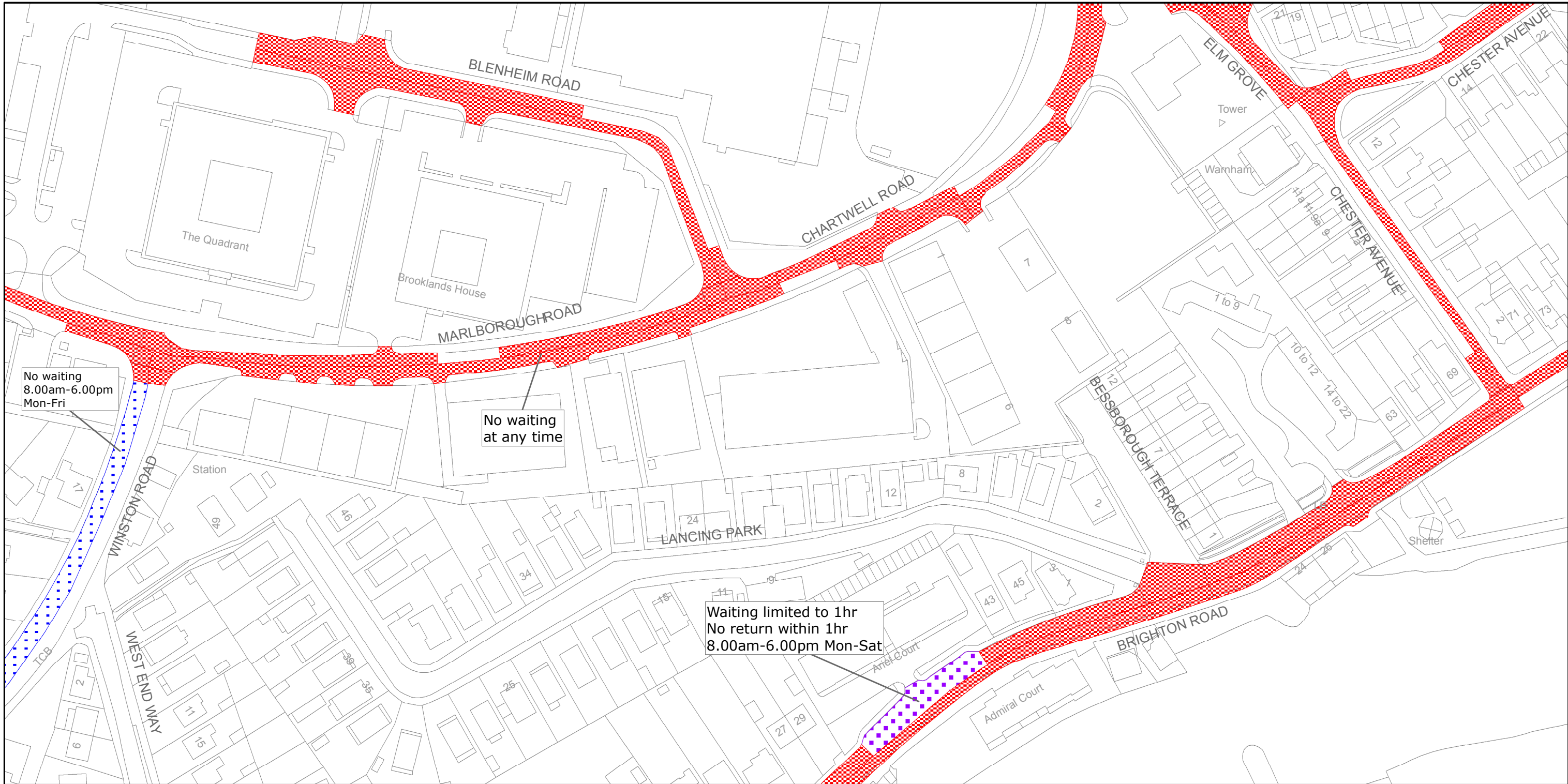

No waiting  
8.00am-6.00pm  
Mon-Fri

No waiting  
at any time

Waiting limited to 1hr  
No return within 1hr  
8.00am-6.00pm Mon-Sat



West Sussex County Council  
Highways & Transport  
The Grange  
Tower Street  
Chichester  
West Sussex  
PO19 1RH

ADUR DISTRICT: LANCING  
WAITING RESTRICTIONS

TILE REF NO:  
TQ1703NES

SHEET ISSUE NO 2  
SHEET ACTIVE FROM - 07/11/2011

N  
SCALE:  
1:1250  
at A3 size

Reproduced from or based upon 2010 Ordnance Survey mapping with permission of the Controller of HMSO (c) Crown Copyright reserved.  
Unauthorised reproduction infringes Crown copyright and may lead to prosecution or civil proceedings West Sussex County Council Licence No. 100018485



West Sussex County Council  
 Highways & Transport  
 The Grange  
 Tower Street  
 Chichester  
 West Sussex  
 PO19 1RH

ADUR DISTRICT: LANCING AND SOMPTING  
 WAITING RESTRICTIONS

Reproduced from or based upon 2010 Ordnance Survey mapping with permission of the Controller of HMSO (c) Crown Copyright reserved.  
 Unauthorised reproduction infringes Crown copyright and may lead to prosecution or civil proceedings West Sussex County Council Licence No. 100018485

TILE REF NO:  
 TQ1703NWN

SHEET ISSUE NO 2

SHEET ACTIVE FROM - 07/11/2011



SCALE:  
 1:1250  
 at A3 size



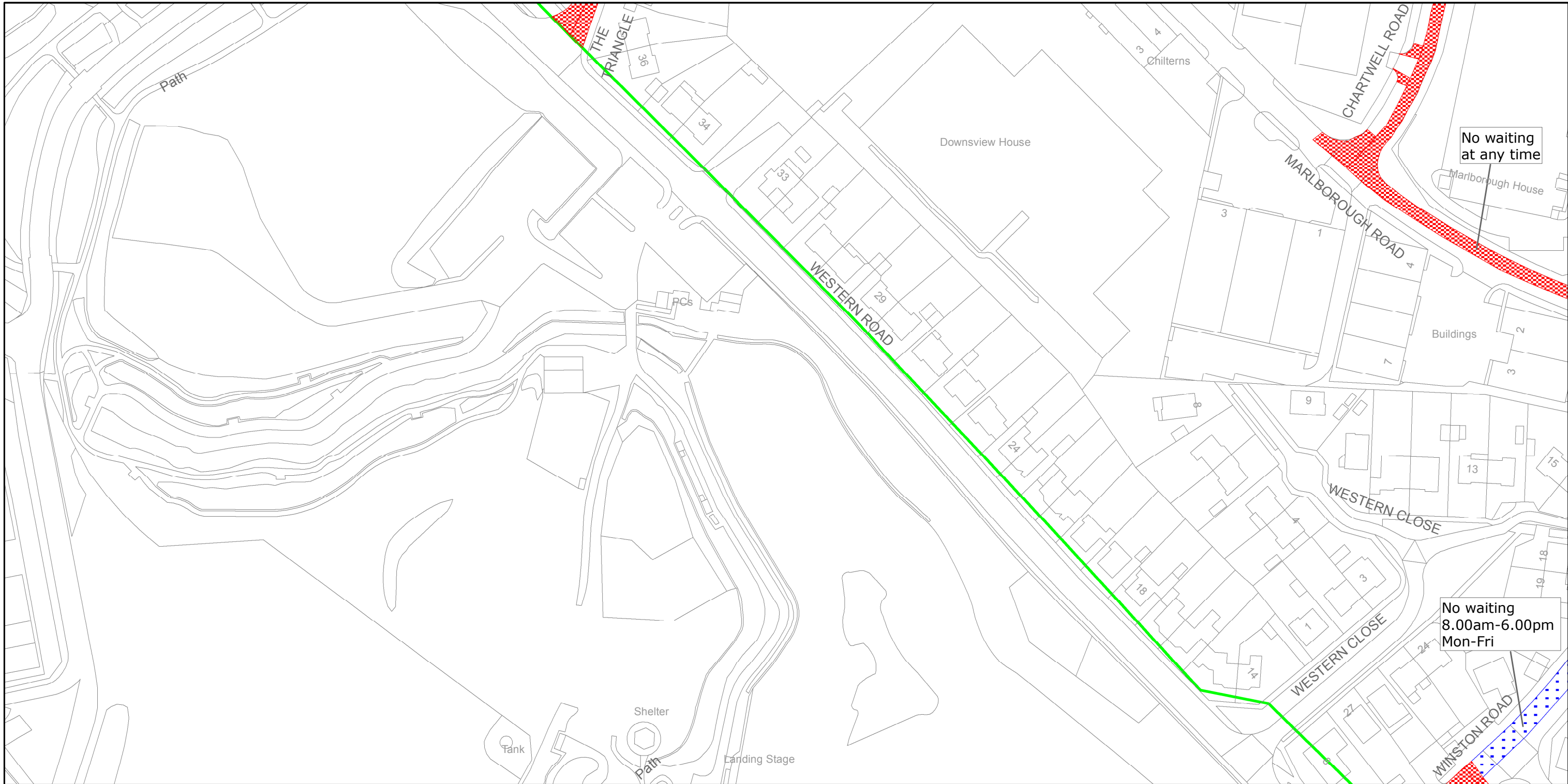

West Sussex County Council  
 Highways & Transport  
 The Grange  
 Tower Street  
 Chichester  
 West Sussex  
 PO19 1RH

ADUR DISTRICT: LANCING AND SOMPTING  
 WAITING RESTRICTIONS

Reproduced from or based upon 2010 Ordnance Survey mapping with permission of the Controller of HMSO (c) Crown Copyright reserved.  
 Unauthorised reproduction infringes Crown copyright and may lead to prosecution or civil proceedings West Sussex County Council Licence No. 100018485

TILE REF NO:  
 TQ1703NWS

SHEET ISSUE NO 2

SHEET ACTIVE FROM - 07/11/2011



SCALE:  
 1:1250  
 at A3 size



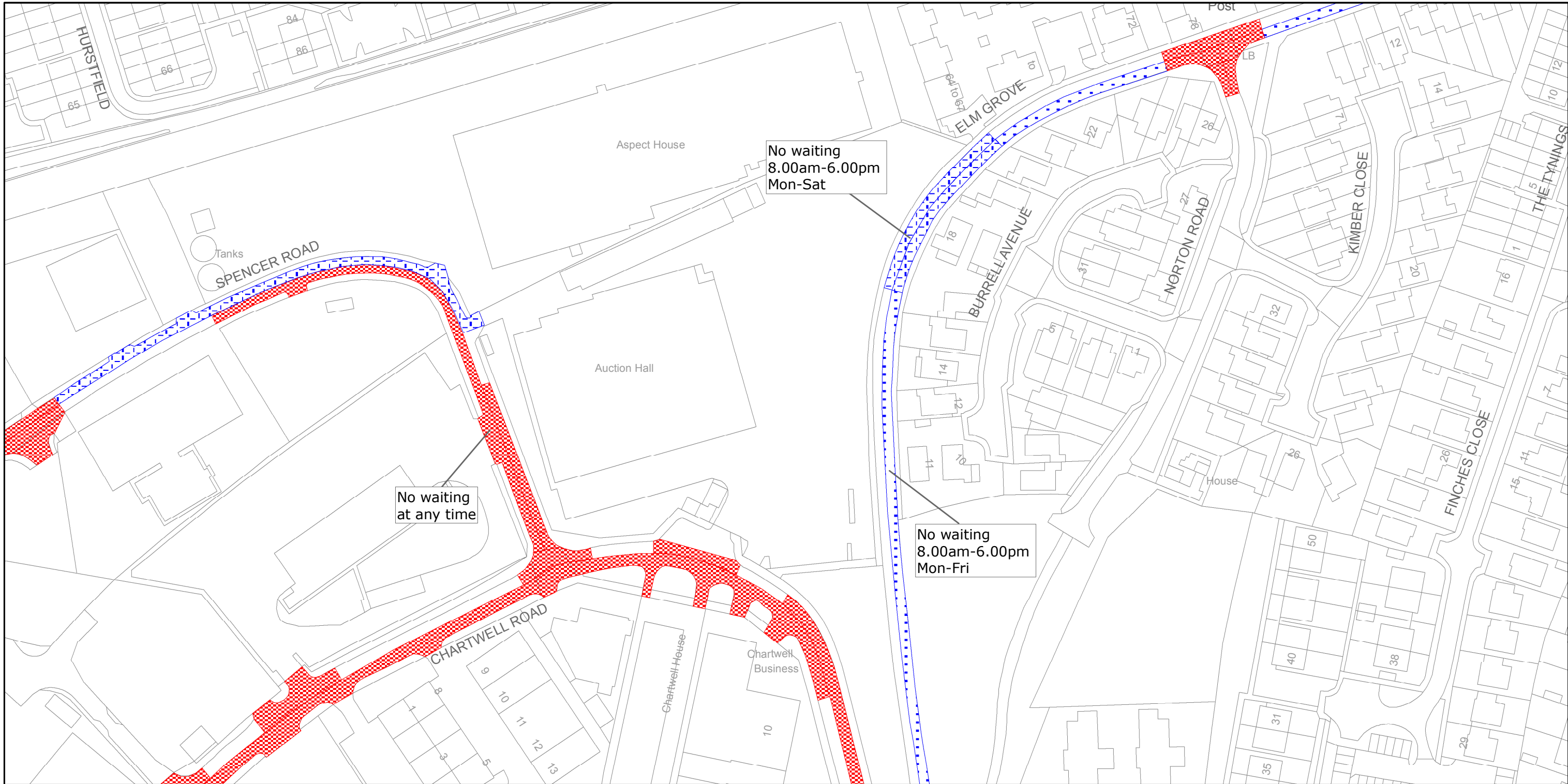

West Sussex County Council  
 Highways & Transport  
 The Grange  
 Tower Street  
 Chichester  
 West Sussex  
 PO19 1RH

ADUR DISTRICT: LANCING  
 WAITING RESTRICTIONS

TILE REF NO:  
 TQ1704SES

SHEET ISSUE NO 2

SHEET ACTIVE FROM - 07/11/2011



SCALE:  
 1:1250  
 at A3 size

Reproduced from or based upon 2010 Ordnance Survey mapping with permission of the Controller of HMSO (c) Crown Copyright reserved.  
 Unauthorised reproduction infringes Crown copyright and may lead to prosecution or civil proceedings West Sussex County Council Licence No. 100018485

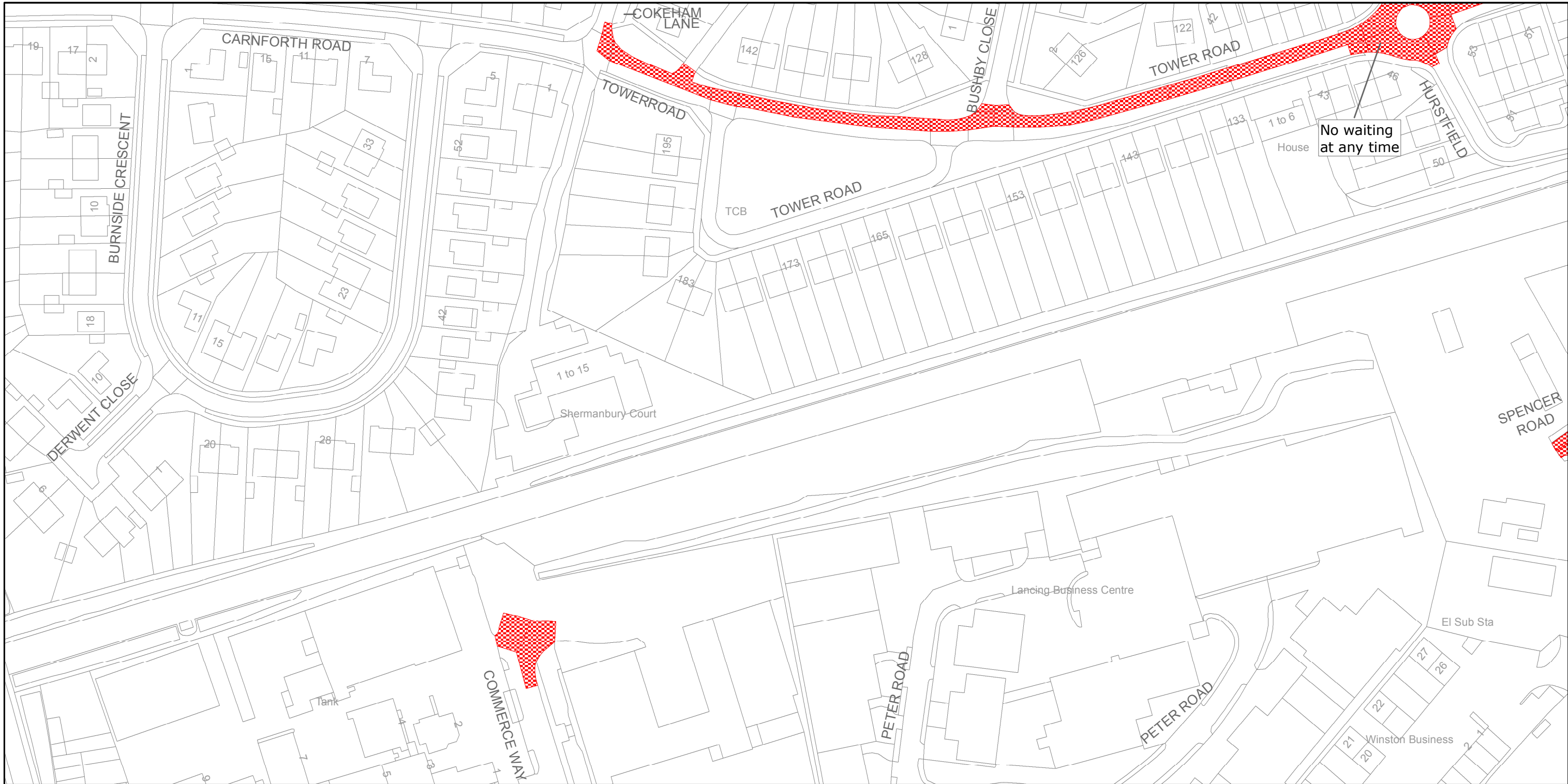

West Sussex County Council  
 Highways & Transport  
 The Grange  
 Tower Street  
 Chichester  
 West Sussex  
 PO19 1RH

ADUR DISTRICT: LANCING AND SOMPTING  
 WAITING RESTRICTIONS

TILE REF NO:  
 TQ1704SWS

SHEET ISSUE NO 2

SHEET ACTIVE FROM - 07/11/2011



SCALE:  
 1:1250  
 at A3 size

Reproduced from or based upon 2010 Ordnance Survey mapping with permission of the Controller of HMSO (c) Crown Copyright reserved.  
 Unauthorised reproduction infringes Crown copyright and may lead to prosecution or civil proceedings West Sussex County Council Licence No. 100018485